

### LED Flood Light XFL Series

Project:	
Catalog#:	
Approved by:	

#### Features

- LED: Lumileds
  - Color Temperature: 5000K (cool white)
  - Color Rendering Index (CRI): > 80
  - Long LED life; L<sub>70</sub> > 60,000 hours\*
  - Rated for Ambient Temperatures up to 40°C/104°F
  - Power Factor (PF) > 0.9
  - Total Harmonic Distribution (THD) < 20%
  - Input Voltage: 120 – 277V; 50/60 Hz
  - Dimmable: 0-10Vdc
  - Beam Angle: 90°x120° (NEMA 7x7)
  - Ultra-durable Powder Coat Paint
  - Standard Color Bronze
  - UL/cUL Listed
  - IP65
  - Warranty: 5 years
- \*L<sub>70</sub> hours are IES TM-21-11 calculated hours.

#### Applications

- Security
- Signs
- Building Facades
- Displays



#### Mounting Options

- Add '-TR' in model configuration for trunnion.
- Slip Fitter (XFL-SF) can be used to attach fixture to a 2 3/8" OD tenon. Fits '-TR' models only.



Visit [www.designlights.org](http://www.designlights.org) for the Qualified Products List



#### Dimensions

Model	A	B	C	D	E	Effective Projected Area (sf)	Weight
XFL-5080	12 5/8	9 7/8	12 3/8	13 1/2	3 7/16	Top 1.04 Side 0.28 Front 0.36	12.0 lbs
XFL-5100							
XFL-5150							
XFL-5220	12 5/8	17	19 1/2	13 1/2	3 5/8	Top 1.79 Side 0.39 Front 0.36	25.0 lbs
XFL-5300							

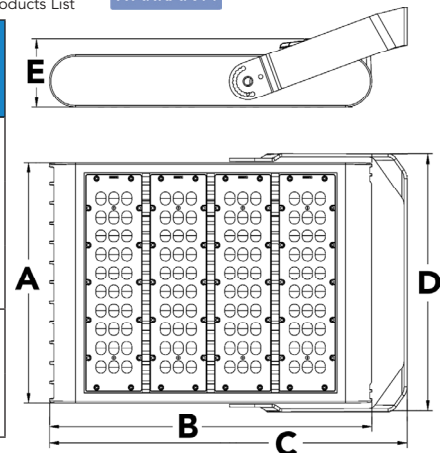

All dimensions in inches

Ordering Information					
Model	CCT	Nominal Input Power	Voltage	Mounting Options	Accessories (order separately)
XFL LED FloodLight	3*: 3000K 4*: 4000K 5: 5000K	080: 80W 100: 100W 150: 150W 220: 220W 300: 300W	LED-MV 120-277V 50/60 Hz	(blank): Yoke TR: Trunnion	XFL-SF**: Slip Fitter for up to 2 3/8" tenon XFGS-S: Full Glare Shield (80W-150W) XFGS-L: Full Glare Shield (220W-300W) XHGS-S: Half Glare Shield (80W-150W) XHGS-L: Half Glare Shield (220W-300W) XWG-S: Wire Guard (80W-150W) XWG-L: Wire Guard (220W-300W)

\*Non-stocked items. \*\* Fits with '-TR' models only – will not mount on fixtures that have yoke.

### LED Flood Light XFL Series

Project:	
Catalog#:	
Approved by:	

### Performance Details & Photometrics

	Output Lumens			Input Power (W)	Efficacy (@5000K) LPW	Comparable to HID
	@3000K CCT	@4000K CCT	@5000K CCT			
<b>XFL-*080 Series</b>	9,725	10,033	10,342	79	131	200W
<b>XFL-*100 Series</b>	10,035	12,105	12,353	99	125	320W
<b>XFL-*150 Series</b>	15,131	18,486	18,752	153	123	400W
<b>XFL-*220 Series</b>	21,578	26,219	26,731	229	117	750W
<b>XFL-*300 Series</b>	30,857	37,597	38,122	306	124	1000W

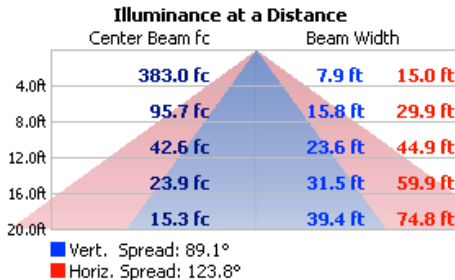
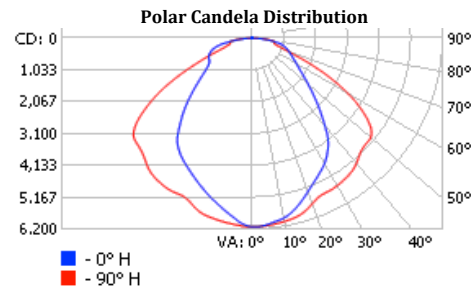
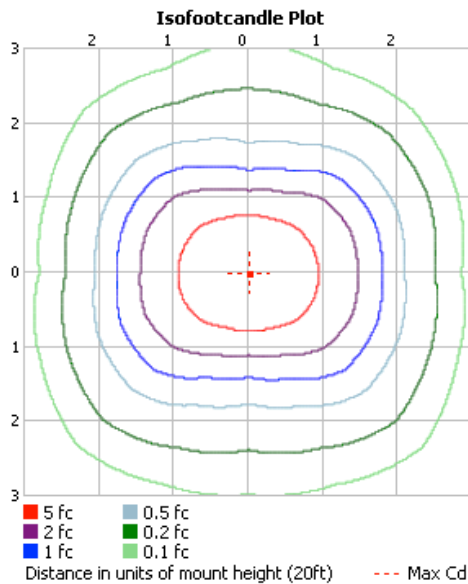

Height	Center Beam Footcandle (fc)					Beam Spread (ft.)	
	080 Series	100 Series	150 Series	220 Series	300 Series	Horizontal	Vertical
4 ft.	199	258	383	575	798	15	8
8 ft.	50	64	96	144	200	30	16
12 ft.	22	29	43	64	89	45	24
16 ft.	12	16	24	36	50	60	32
20 ft.	8	10	15	23	32	75	39
						Beam Angle	
						124°	89°

### Accessories



**XFL/XAL-SF:** Slip Fitter

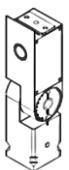

**XHGS-S:** Half Glare Shield (80W-150W)  
**XHGS-L:** Half Glare Shield (220W-300W)

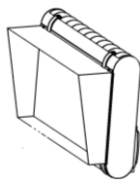

**XFGS-S:** Full Glare Shield (80W-150W)  
**XFGS-L:** Full Glare Shield (220W-300W)

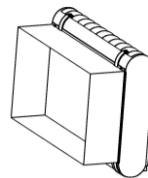

**XWG-S:** Wire Guard (80W-150W)  
**XWG-L:** Wire Guard (220W-300W)

